

### EPX-AD-ZIF33.Y4

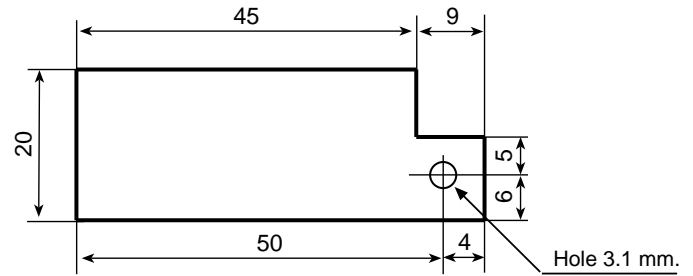
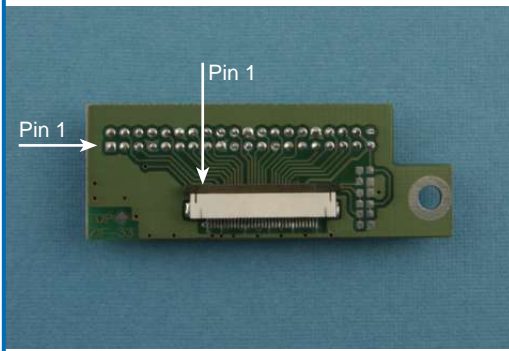

Adapter <b>EPX-AD-ZIF33.Y4</b>		
Housing pitch 2mm. 2x20 Pins	Signal	ZIF Header SMT 0.5 mm. - 33 Pos.
1	N.C.	
2	N.C.	
3	ENAB	27
4	H Sync.	3
5	V Sync.	4
6	CLK	2
7	Bus GND	
8	N.C.	
9	N.C.	
10	RE0	6
11	RE1	7
12	Bus GND	
13	RE2	8
14	RE3	9
15	RE4	10
16	RE5	11
17	Bus GND	
18	N.C.	
19	N.C.	
20	GE0	13
21	GE1	14
22	Bus GND	
23	GE2	15
24	GE3	16
25	GE4	17
26	GE5	18
27	Bus GND	
28	N.C.	
29	N.C.	
30	BE0	20
31	BE1	21
32	Bus GND	
33	BE2	22
34	BE3	23
35	BE4	24
36	BE5	25
37	Bus GND	
38	Bus VCC	
39	Bus VCC	
40	N.C.	
	Bus VCC	28, 29, <b>31, 32</b>
	Bus GND	1, 5, 12, 19, 26, 33, <b>30</b>

Included FFC cable 33 pin - lenght 200 mm - pitch 0.5 mm  
The photos are purely indicative of the model and the connectors polarization.