

EPX-AD-ZIF40.Y1

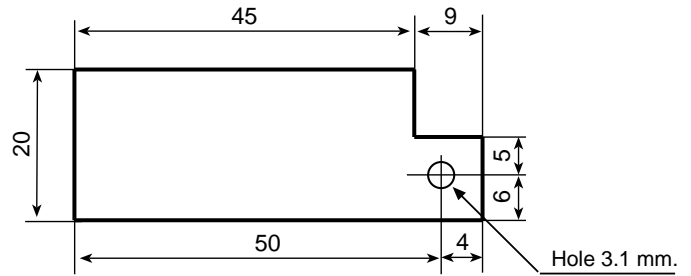
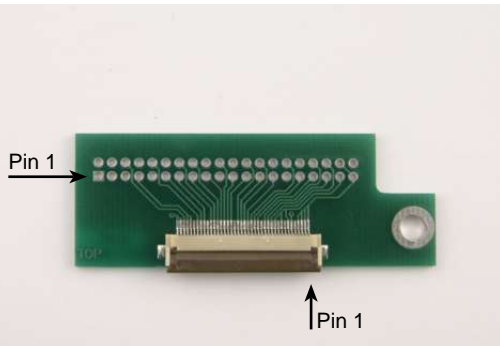

Adapter EPX-AD-ZIF40.Y1		
Housing pitch 2mm. 2x20 Pins	Signal	ZIF Header SMT 0.5 mm. - 40 Pos.
1	N.C.	
2	N.C.	
3	ENAB	10
4	H Sync	14
5	V Sync	12
6	CLK	38
7	Bus GND	
8	N.C.	
9	N.C.	
10	RE0	35
11	RE1	34
12	Bus GND	
13	RE2	33
14	RE3	32
15	RE4	31
16	RE5	30
17	Bus GND	
18	N.C.	
19	N.C.	
20	GE0	28
21	GE1	27
22	Bus GND	
23	GE2	26
24	GE3	25
25	GE4	24
26	GE5	23
27	Bus GND	
28	N.C.	
29	N.C.	
30	BE0	21
31	BE1	20
32	Bus GND	
33	BE2	19
34	BE3	18
35	BE4	17
36	BE5	16
37	Bus GND	
38	Bus VCC	
39	Bus VCC	
40	N.C.	
	Bus VCC	1, 2, 3, 4
	Bus GND	5, 7, 9, 11, 13, 15, 29, 36, 37, 39, 40

Included ZIF cable 40 pos. lenght 200 mm.

The photos are purely indicative of the model and the connectors polarization.